

*Miranda*  
The European Bike Fundamentals.

20  
26

CITY &  
TREKKING  
CATALOG

*Miranda*

Miranda & Irmão, established in 1950, has a rich legacy and extensive expertise, honed over the decades through a journey that began with complementary bicycle components in the 50s, the motorcycle industry in the early 70s and culminated in bicycle components again in the late 80s. Today, Miranda is a leading manufacturer of bicycle components, recognized for its unparalleled reliability, quality, and design excellence. The company's commitment to innovation and research and development has resulted in numerous awards and recognition as one of the largest companies investing in innovation and international IP, within Portugal.

As a cutting-edge, industry-leading company, Miranda leverages the latest in Industry 4.0 technology and innovative manufacturing techniques to continuously optimize its production processes and workflows. The company's world-class factory is one of the most advanced in the industry, boasting a footprint of over 30000 sqm and near 100% control over its production processes. This control allows Miranda to continuously experiment with new approaches and test new materials and techniques, resulting in unique, high-quality solutions. Additionally, the company's commitment to environmental preservation is demonstrated through its use of 100% renewable electricity and its focus on reducing waste and investing in energy-efficient machinery.

Miranda's strategic location, less than an hour from a major airport and sea port in Porto and within 3 hours of a plane ride to the center of Europe, further strengthens its competitive advantage. The company's technical know-how is supported by its own World Class Professional Teams, who test and refine its solutions through rigorous competition. In 2020, Miranda was the World Champion in the first ever global e-Bike competition, with its athletes consistently taking the podium in the following years.

A large, stylized white logo for 'Miranda' is positioned at the bottom of the page. The letters are bold and modern, with the 'M' being particularly prominent. The logo is set against a solid orange background that matches the top section of the page.



The company's commitment to excellence is reflected in its rapid response to customer needs and its ability to produce high-quality, value-added solutions that are tailored to meet their specific requirements. Miranda's lead times are market-leading, a result of its substantial investment in manufacturing capacities and its ability to rapidly understand and solve problems in a cost-effective manner.

As a bicycle components leader with established "green" manufacturing practices, Miranda is paving the way for the bicycle industry around the world. Our commitment to constantly improve and deliver exceptional products is unwavering and we are here to serve you.

# Miranda



**AENOR**

GESTÃO  
DE QUALIDADE

ISO 9001

**AENOR**

QUALIDADE NO  
SETOR AUTOMÓVEL

IATF 16949

**AENOR**

GESTÃO  
AMBIENTAL

ISO 14001



Cranksets with a single chainring



Cranksets with dual chainrings



Cranksets with three chainrings



Interchangeable cranksets parts



Cranksets with integrated axle



ISIS Interface Standard



JIS square taper Standard



BNI Interface for Bosch Gen3



Dual side Screws Shimano Interface



Dual side Screws Shimano Interface for EP Drive Units



Fazua RIDE 60 Interface



Dual side Screws Bafang Interface for M420, M500, M600 and M800



Titanium Crankset



Interchangeable cranksets parts

## CRANKSET



Bottom Bracket BSA 68/73 with 24/22 Size



Bottom Bracket BSA 68/73 with 24/24 Size



Bottom Bracket Pressfit with 24/22 Size



Bottom Bracket Pressfit with 24/24 Size

## BOTTOM BRACKETS



Economical chainring option



Bi-dimensional Anti-chaindrop control



Shifting without Drops



Carbon Nanoscaled Coating



Tri-dimensional Anti-chaindrop control 9-10-11-12 speed



Tri-dimensional Anti-chaindrop control specific for Shimano Hyperglide+ and DLC 12 KMC



Tri-dimensional Anti-chaindrop control specific for 13 speed EKAR C13 Campagnolo

## CHAINRINGS TECHNOLOGY



Easy and fast installation



Durable and resistant Carbon reinforced

## SEAT POST

## CABLE CLAMPS





# CITY & TREKKING Index

Crank Models	7
XMOD City/Trekking	13
MGreen	19
Bottom Brackets	21
Cranksets	23
Chainrings	31
Chainguards	33
Screws	35
Finishes	37
Belt Line Guide	37
Chain Compatibility	38



A man with a backpack is riding a bicycle on a red-paved city street. In the background, there is a modern building with a facade of vertical blue slats. A pedestrian is walking on a sidewalk to the left. The scene is brightly lit, suggesting a sunny day.

As the world of cycling expands to embrace city and trekking enthusiasts, Miranda is once again at the forefront, offering a diverse range of products tailored to meet the unique needs of urban riders.

Located in Águeda, Portugal, our state-of-the-art in-house production process ensures that we can easily adapt to the evolving demands of the industry. With a deep understanding of the urban landscape and the challenges it presents, we have developed a range of components that excel in both performance and durability.

Our commitment to customization sets us apart. While each product in this section is listed with standard specifications, we offer something extra – the option to supply a proprietary design to Miranda. This unique opportunity allows bike manufacturers to customize components to their exact specifications, ensuring a perfect fit for their urban riding needs.

Within this city and trekking catalogue, you will find a comprehensive range of components meticulously designed to enhance your urban riding experience. From innovative and reliable drivetrain systems to cutting-edge components produced with recycled materials and green energy, our products are engineered to handle the challenges of the city streets and scenic treks.

Whether you're commuting to work, cruising through city streets, or embarking on long-distance treks, Miranda Bike Parts is here to provide you with the cutting-edge components you need to unlock the full potential of your urban adventures.



# ***CITY & TREKKING SOLUTIONS***









# CRANK

## MODELS

### **The Ultimate Properties of our Cold-Forged Aluminium Bike Cranks: An Engineering Marvel**

Our bike cranks have been designed with a single purpose in mind: to eliminate any and all weak points in their structure. The use of proprietary cold-forging techniques, along with a carefully crafted composition of materials, has allowed us to create cranks that are not only lightweight, but also incredibly resistant to fatigue and high-impact stress. Also, are environmentally friendly, since we use recycled aluminium and 100% green electricity to produce them.

Moreover, the use of advanced computational simulations and extensive real-world testing has allowed us to fine-tune the design of the cranks to ensure that they perform at the highest level possible. The result is a product that is not only lightweight, but also incredibly durable and reliable, making it an ideal choice for bike enthusiasts who demand the best performance from their equipment.

The cold-forging process involves subjecting the aluminium to intense pressure and temperature, which not only strengthens the material, but also refines its microstructure to create a more homogeneous and consistent structure. Our process has several advantages, since we do it uniquely and in a fully automatic way, keeping the properties of material always stable, ensuring the highest quality standards. Our process, made entirely in Portugal, allows our cranks to be more resistant to fatigue and high-impact stress.

If you're looking for cranks that are strong, reliable and built to last, look no further than our bike cranks.

## Delta

REF. 003

MGreen *Miranda*  
**X700** **HOLLOW**  
TUBE **ISIS** **JIS**

### Material

Aluminium

### Length (mm)

150 . 152 . 155 . 160  
165 . 170 . 172,5 . 175

### Weight (g)\*

245

### Finishes\*\*

Standard  
Polished  
Diamant  
Double Diamant  
Pearl  
Plus  
Inline  
Inline Plus  
Graphic  
HD

CRANK Q-FACTORS	A	B	C	D
Q:0	0 mm	27,1 mm	10,5 mm	14,1 mm
Q:4	4 mm	27,1 mm	10,5 mm	18,1 mm
Q:8	8,1 mm	27,1 mm	10,5 mm	22,2 mm
Q:8FB	8,1 mm	30,1 mm	13,5 mm	25,2 mm
Q:16	16,1 mm	27,1 mm	10,5 mm	30,2 mm
55Q:16	16,1 mm	32,6 mm	16 mm	35,7 mm
Q:16-UC	16,1 mm	38,9 mm	22,3 mm	42 mm
Q:19	19,1 mm	27,1 mm	10,5 mm	33,2 mm
Q:21FB	21,1 mm	30,1 mm	13,5 mm	38,2 mm
55Q:21	21,1 mm	32,6 mm	16 mm	40,7 mm
Q:29,5-UC	29,6 mm	38,9 mm	22,3 mm	55,5 mm
55Q:29,5	29,6 mm	32,6 mm	16 mm	49,2 mm
Q:35	35,1 mm	27,1 mm	10,5 mm	49,2 mm
55Q:35	35,1 mm	32,6 mm	16 mm	54,7 mm
Q:38	38,1 mm	27,1 mm	10,5 mm	52,2 mm

\*crank (ISIS 170/Q:16) without bolt

\*\*Samples of the finishes on page 37

## Epsilon

REF. 005

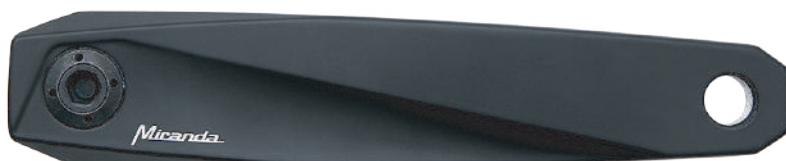
*Miranda*  
**X700** **HOLLOW**  
TUBE **ISIS** **JIS**

### Material

Aluminium

### Length (mm)

165 . 170 .175

### Weight (g)\*

201

### Finishes\*\*

Standard

CRANK Q-FACTORS	A	B	C	D
Q:0	0 mm	27,1 mm	10,5 mm	14,1 mm
Q:4	4 mm	27,1 mm	10,5 mm	18,1 mm
Q:8	8,1 mm	27,1 mm	10,5 mm	22,2 mm
55Q:8	8 mm	32,7 mm	12,5 mm	27,7 mm
Q:16	16 mm	27,2 mm	10,5 mm	30,2 mm
55Q:21	21,1 mm	32,6 mm	16 mm	40,7 mm
Q:35	35,1 mm	27,1 mm	10,5 mm	49,2 mm

\*crank (ISIS 165/Q:8) without bolt

\*\*Samples of the finishes on page 37

# Kappa

REF.006

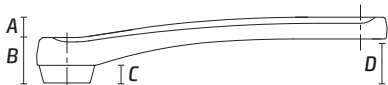

**Material**  
Aluminium

**Length (mm)**  
150 . 155 . 160  
170 . 175

**Weight (g)\***  
227

**Finishes\*\***  
Standard

CRANK Q-FACTORS	A	B	C	D
Q:0	0 mm	27,1 mm	10,5 mm	14,1 mm
Q:4	4 mm	27,1 mm	10,5 mm	18,1 mm
Q:8	8,1 mm	27,1 mm	10,5 mm	22,2 mm
Q:16	16,1 mm	27,1 mm	10,5 mm	30,2 mm
Q:21	21,1 mm	27,1 mm	10,5 mm	35,2 mm
Q:35	35,1 mm	27,1 mm	10,5 mm	49,2 mm

\*crank (ISIS 170/Q:0) without bolt  
\*\*samples of the finishes on page 37

# Omega

REF. 007



**Material**  
Aluminium

**Length (mm)**  
150 . 152 . 155  
160 . 165 . 170

**Weight (g)\***  
222

**Finishes\*\***  
Standard  
Polished  
Diamant  
Double Diamant

CRANK Q-FACTORS	A	B	C	D
Q:0	0 mm	27,1 mm	10,5 mm	14,1 mm
Q:4	4 mm	27,1 mm	10,5 mm	18,1 mm
Q:8	8,1 mm	27,1 mm	10,5 mm	22,2 mm
Q:16	16 mm	27,2 mm	10,5 mm	30,2 mm

\*crank (ISIS 160/Q:16) without bolt  
\*Samples of the finishes on page 37

Sigma

REF. 008



Material  
Aluminium

Length (mm)  
160 . 165 .170

Weight (g)\*  
250

Finishes\*\*  
Standard

CRANK Q-FACTORS	A	B	C	D
Q:8	8,1 mm	27,1 mm	10,5 mm	22,2 mm
Q:12	12,1 mm	27,1 mm	10,5 mm	26,2 mm
Q:16	16,1 mm	27,1 mm	10,5 mm	30,2 mm

\*crank (ISIS 170/Q:16) without bolt  
\*\*samples of the finishes on page 37

Kies

REF. 009



Material  
Aluminium

Length (mm)  
160 . 165 .170

Weight (g)\*  
240

Finishes\*\*  
Standard

CRANK Q-FACTORS	A	B	C	D
Q:8	8,1 mm	27,1 mm	10,5 mm	22,2 mm
Q:12	12,1 mm	27,1 mm	10,5 mm	26,2 mm

crank (ISIS 170/Q:16) without bolt  
\*\*samples of the finishes on page 37



# Tethys

REF. 013



**Material**  
Aluminium

**Length (mm)**  
150 . 152 . 155  
160 . 165 . 170

**Weight (g)\***  
240

**Finishes\*\***  
Standard

CRANK Q-FACTORS	A	B	C	D
Q:0	0 mm	27,1 mm	10,5 mm	14,1 mm
Q:4	4 mm	27,1 mm	10,5 mm	18,1 mm
Q:8	8,1 mm	27,1 mm	10,5 mm	22,2 mm
Q:16	16 mm	27,2 mm	10,5 mm	30,2 mm

\*crank (ISIS 170/Q:16) without bolt  
\*\*samples of the finishes on page 37

[www.mirandabikeparts.com](http://www.mirandabikeparts.com)





**Micanda**  
**X4000**  
CITY/TREKKING

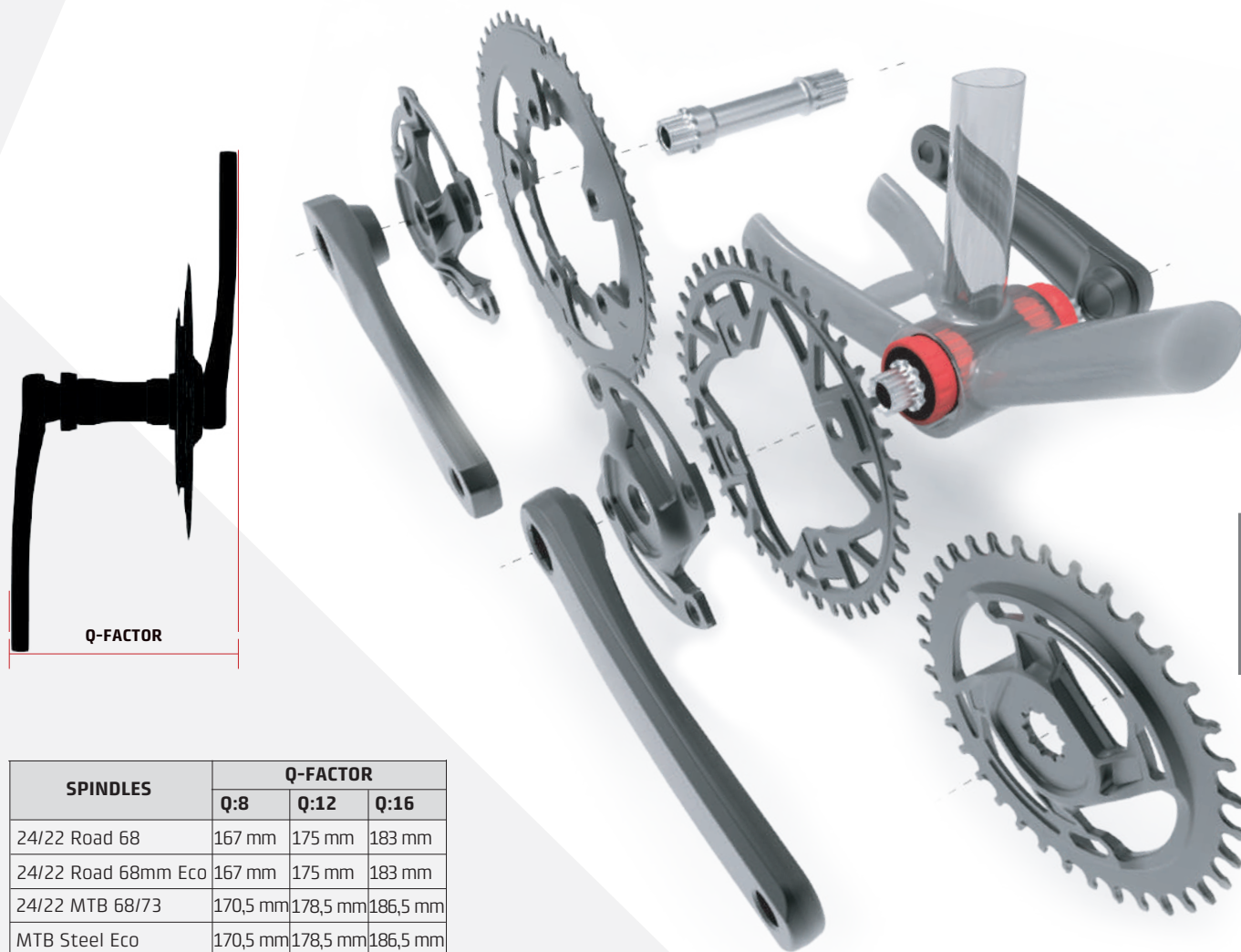

XMOD

SPINDLES	Q-FACTOR		
	Q:8	Q:12	Q:16
24/22 Road 68	167 mm	175 mm	183 mm
24/22 Road 68mm Eco	167 mm	175 mm	183 mm
24/22 MTB 68/73	170,5 mm	178,5 mm	186,5 mm
MTB Steel Eco	170,5 mm	178,5 mm	186,5 mm

## Crankset Xmod Classic CF3D

In order to choose tooth type please check chain compatibility in page 38

Other cranks from page 7 to 12

Any sizes, finishes and Q-factors by request

\*other chainlines available by request

\*\*with 44T Chainring



### SPECIFICATIONS REF. 700

**Material**  
Aluminium

**Teeth**  
32T to 52T and 56T

**Chainline (mm)\***  
Standard - 51

**Weight (g)\*\***  
584

**Finishes**  
Standard



SPIDERS



Spider XM BCD104



AVAILABLE  
CHAINRINGS  
PAGE 31



AVAILABLE  
CHAINGUARDS  
PAGE 33

SPECIFICATIONS  
REF. 159

BCD  
104

Material  
Aluminium

Weight (g)  
84

Finishes\*  
Standard

SPINDLES	FRAME SHEEL	SPACER** DRIVER SIDE	SPACER** LEFT SIDE	CL Single* (inside)	CL Single* (outside)	CL Double	BOTTOM BRACKET
24/22 ROAD	68 mm	-----	-----	44,5 mm	51,5 mm	48,5 mm	Miranda GXP
24/22 MTB	68 mm	2	-----	50,5 mm	57,5 mm	54,5 mm	Miranda GXP
24/22 MTB	68 mm	1	1	48 mm	55 mm	52 mm	Miranda GXP
24/22 MTB	68 mm	-----	2	45,5 mm	52,5 mm	49,5 mm	Miranda GXP
24/24 GRAVEL Single	68 mm	-----	-----	45,5 mm	52 mm	49 mm	Miranda 24/24 ROAD
24/24 GRAVEL Single	68 mm	1	-----	46,5 mm	53 mm	50 mm	Miranda 24/24 MTB
24/24 GRAVEL Single	68 mm	-----	1	44 mm	50,5 mm	47,5 mm	Miranda 24/24 MTB

In order to choose your spindle ckeck page 18  
\*chainlines measured with chainwheel CF3D / other chainlines available by request  
\*\*2,5mm spacer



## Spider DOUBLE110/74



### SPECIFICATIONS

REF. 160

**BCD**  
110/74

**Material**  
Aluminium

**Weight (g)**  
105

**Finishes\***  
Standard

SPINDLES	FRAME SHEEL	SPACER** DRIVER SIDE	SPACER** LEFT SIDE	CL Single* (inside)	CL Single* (outside)	CL Double	BOTTOM BRACKET
24/22 ROAD	68 mm	-----	1	48,5 mm	55,5 mm	45 mm	Miranda GXP
24/22 MTB	68 mm	2	-----	54,5 mm	61,5 mm	51 mm	Miranda GXP
24/22 MTB	68 mm	1	1	52 mm	59 mm	48,5 mm	Miranda GXP
24/22 MTB	68 mm	-----	2	49,5 mm	56,5 mm	46 mm	Miranda GXP
24/24 GRAVEL Single	68 mm	-----	-----	49,5 mm	56 mm	45,5 mm	Miranda 24/24 ROAD
24/24 GRAVEL Single	68 mm	1	-----	50,5 mm	57 mm	46,5 mm	Miranda 24/24 MTB
24/24 GRAVEL Single	68 mm	-----	1	48 mm	54,5 mm	44 mm	Miranda 24/24 MTB

In order to choose your spindle ckeck page 18

\*chainlines measured with chainwheel CF3D / other chainlines available by request

\*\*2,5mm spacer

[www.mirandabikeparts.com](http://www.mirandabikeparts.com)









# SPINDLES

## 24/22 ROAD 68mm



REF. 516  
Material  
Titanium

Length (mm)  
128,5  
Weight (g)  
95

ROAD

## 24/22 ROAD 68mm ECO



REF. 517  
Material  
Steel

Length (mm)  
128,5  
Weight (g)  
167

ROAD

## 24/22 MTB



REF. 510  
Material  
Titanium

Length (mm)  
132  
Weight (g)  
147

MTB

## 24/22 MTB ECO



REF. 511  
Material  
Steel

Length (mm)  
132  
Weight (g)  
256

MTB

## 24/24 GRAVEL Single



REF. 502  
Material  
Titanium

Length (mm)  
125,5  
Weight (g)  
107

GR SINGLE

## 24/24 GRAVEL Single ECO **NEW**



REF. 503  
Material  
Steel

Length (mm)  
125,5  
Weight (g)  
189

GR SINGLE



# MGreen

## *Miranda*

The MGreen Crankset is a revolutionary product designed with sustainability and innovation at its core. Crafted from the principles of ecodesign, this patented system stands as a pioneering alternative to traditional cranksets commonly found in the market.

What sets the MGreen Crankset apart is its unique design that allows the separation of its two primary components: the chainring, constructed from durable steel, and the crank arm, forged from lightweight aluminium. This innovative feature deviates from the conventional clamped cranksets, offering a range of benefits that align with our commitment to sustainability.

In the event of a component failure, this design allows for the replacement of only the damaged part, significantly reducing waste by preserving the part that remains in good condition. Furthermore, when the crankset reaches the end of its life cycle, the ability to separate its components simplifies the recycling process. By facilitating the easy segregation of the two different materials - steel and aluminium - we ensure a more efficient and environmentally conscious recycling method.

The MGreen Crankset is not merely a component of a bicycle; it's a testament to our dedication towards creating products that respect and protect our environment. With every MGreen Crankset you choose, you are investing in a future where cycling and sustainability go hand in hand.



# Crankset MGreen Delta CF3D

In order to choose tooth type please check chain compatibility in page 38  
Any sizes, finishes, Q-factors and chainlines by request  
\* other sizes available by request  
\*\* With 34T Direct mount



## SPECIFICATIONS

REF. 701

**Material**  
Aluminium  
Steel

**Teeth\***  
28T to 36T

**Weight (g)\*\***  
741

**Finishes**  
Standard

## ASSEMBLY INSTRUCTIONS

TOOLS:

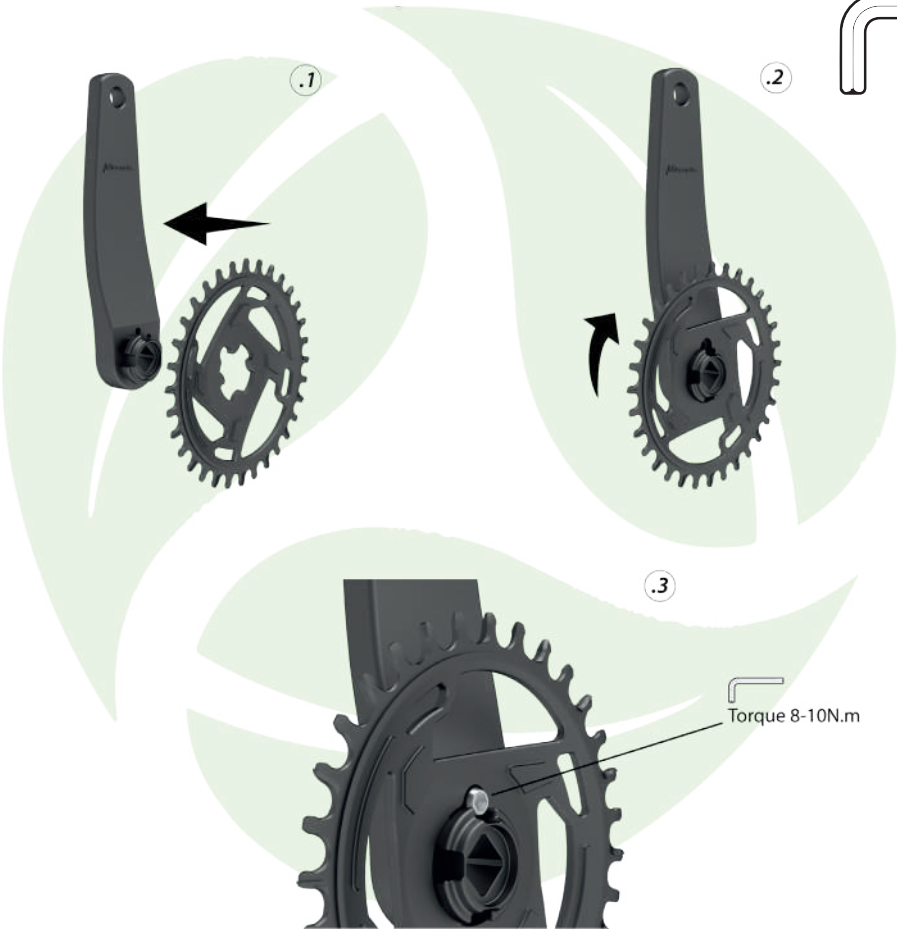

# BOTTOM BRACKETS

## Miranda - GXP® compatible

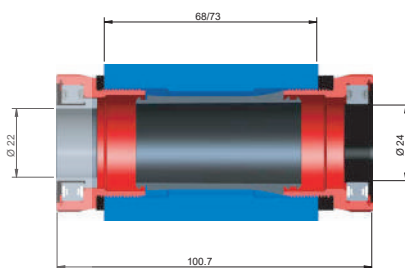

### SPECIFICATIONS

REF. 600

**Frame type**  
BSA 68/73

**Weight (g)**  
112

**Size**  
24/22

**Material**  
Aluminium

## Miranda Pressfit Bottom Bracket

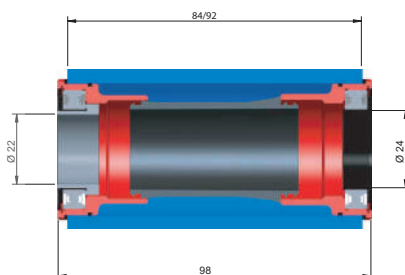

### SPECIFICATIONS

REF. 601

**Frame type**  
Press Fit

**Weight (g)**  
99

**Size**  
24/22

**Material**  
Aluminium

## BB30 Press Fit Adapter



### SPECIFICATIONS

REF. 602

**Weight (g)**  
96

**Size**  
24/22

**Material**  
Aluminium

## Miranda 24/24 Road - compatible

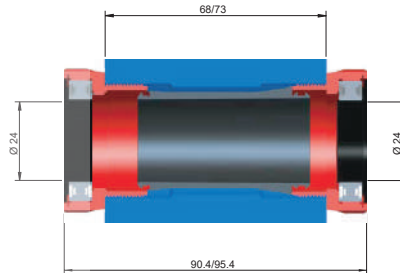

### **SPECIFICATIONS**

REF. 603

**Frame type**  
BSA 68/73

**Weight (g)**  
107

**Size**  
24/24

**Material**  
Aluminium

## Miranda 24/24 MTB - compatible

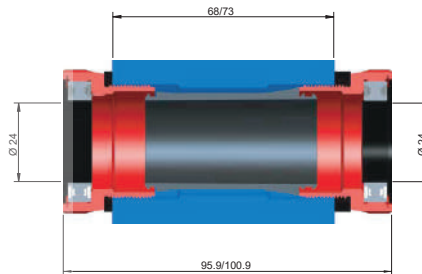

### **SPECIFICATIONS**

REF. 604

**Frame type**  
BSA 68/73

**Weight (g)**  
112

**Size**  
24/24

**Material**  
Aluminium

## Miranda Pressfit 24/24

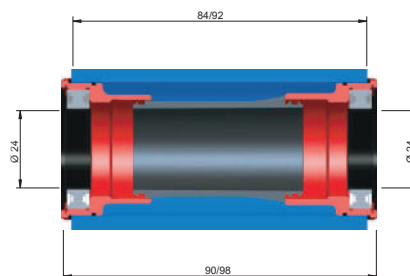

### **SPECIFICATIONS**

REF. 605

**Frame type**  
Press Fit

**Weight (g)**  
99

**Size**  
24/24

**Material**  
Aluminium

## Delta HT Spiderless CF3D

Any sizes, finishes and Q-factors by request  
Other cranks from page 7 to 12  
\* with 32T Direct mount



### SPECIFICATIONS

REF. 702

**Chainring Material**  
Steel

**Length (mm)**  
150 . 152 . 155 . 160  
165 . 170 . 172,5 . 175

**Weight (g)\***  
814

**Teeth**  
30T . 32T



# CRANKSET 1X

## Delta Spiderless CF

In order to choose tooth type please check chain compatibility in page 38  
Other cranks from page 7 to 12  
Any sizes, finishes and Q-factors by request



### SPECIFICATIONS

REF. 703

**Chainring Material**  
Steel

**Length (mm)**  
150 . 152 . 155 . 160  
165 . 170 . 172,5 . 175

**Weight (g)**  
814

**Teeth**  
32T

## Delta Spiderless

In order to choose tooth type please check chain compatibility in page 38  
Other cranks from page 7 to 12  
Any sizes, finishes and Q-factors by request



### SPECIFICATIONS

**Chainring Material**  
Steel

**Length (mm)**  
150 . 152 . 155 . 160  
165 . 170 . 172,5 . 175

**Weight (g)**  
680

**Teeth**  
32T, 36T, 38T, and  
42T to 46T



Cover available

### SPECIFICATIONS

**Weight (g)**  
24

**Size (mm)**  
92 . 95 . 110

**Finishes**  
Black  
Black shinny  
Black sand blast  
Gray  
Chrome plating  
White





## Delta 1R NW Chainguard NW

In order to choose tooth type please check chain compatibility in page 38  
Other cranks from page 7 to 12  
Any sizes, finishes and Q-factors by request



### SPECIFICATIONS

**Chainring Material**  
Steel

**Length (mm)**  
150 . 152 . 155 . 160  
165 . 170 . 172,5 . 175

**Weight (g)**  
711

**Teeth**  
32T to 52T

## Delta 1R Beta Chainguard ST

In order to choose tooth type please check chain compatibility in page 38  
Other cranks from page 7 to 12  
Any sizes, finishes and Q-factors by request  
\*with 52T Chainring



### SPECIFICATIONS

**Chainring Material**  
Steel

**Length (mm)**  
150 . 152 . 155 . 160  
165 . 170 . 172,5 . 175

**Weight (g)\***  
829

**Teeth**  
32T to 52T

# Delta GAZ Chainguard

In order to choose tooth type please check chain compatibility in page 38  
Other cranks from page 7 to 12  
Any sizes, finishes and Q-factors by request  
\*with 42T Direct mount



## SPECIFICATIONS

**Chainring Material**  
Steel

**Length (mm)**  
150 . 152 . 155 . 160  
165 . 170 . 172,5 . 175

**Weight (g)\***  
784

**Teeth**  
32T, 38T, 42T and 44T



[www.mirandabikeparts.com](http://www.mirandabikeparts.com)

## Beta 2R

In order to choose tooth type please check chain compatibility in page 38  
Other cranks from page 7 to 12  
Any sizes, finishes and Q-factors by request



### SPECIFICATIONS

REF. 709

**Chainring Material**  
Aluminium

**Length (mm)**  
170 . 175

**BCD (mm)**  
104

**Weight (g)\***  
862

**Teeth**  
26/39T . 28/40T . 36/48T



# CRANKSET 2X



# Beta 2R 5-arms

In order to choose tooth type please check chain compatibility in page 38  
Other cranks from page 7 to 12  
Any sizes, finishes and Q-factors by request  
\* with 42/52T Chainring



## SPECIFICATIONS

REF. 710

**Chainring Material**  
Steel

**Length (mm)**  
170 . 175

**BCD (mm)**  
110

**Weight (g)\***  
961

**Teeth**  
34/50T . 42/52T

[www.mirandabikeparts.com](http://www.mirandabikeparts.com)



Miranda

## Alfa 3R

In order to choose tooth type please check chain compatibility in page 38

Other cranks from page 7 to 12

Any sizes, finishes and Q-factors by request

\* with 22/32/42T Chainring



### SPECIFICATIONS

REF. 712

**Chainring Material**  
Steel

**Length (mm)**  
170

**BCD (mm)**  
104

**Weight (g)**  
927

**Teeth**  
22/32/42T . 22/32/44T  
28/36/48T . 28/38/48T



# CRANKSET 3X





Miranda

## Delta 3R Chainguard CNC Beta

In order to choose tooth type please check chain compatibility in page 38  
Other cranks from page 7 to 12  
Any sizes, finishes and Q-factors by request  
\* with 22/32/42T Chainring



### SPECIFICATIONS

REF. 711

**Chainring Material**  
Aluminium

**Length (mm)**  
150 . 152 . 155 . 160  
165 . 170 . 172,5 . 175

**BCD (mm)**  
104

**Weight (g)\***  
959

**Teeth**  
22/32/42T . 22/32/44T  
28/36/48T . 28/38/48T





# CHAINRINGS

## Chainflow 3D BCD110



### SPECIFICATIONS

REF. 300

**Material**  
Aluminium

**Teeth\***  
34T to 50T

**Weight (g)**  
45 to 150

**Finishes**  
Anodized

\* other sizes available by request  
In order to choose tooth type please check chain compatibility in page 38

## Chainflow 3D BCD104



\* other sizes available by request

\*\* with 32T Chainring

In order to choose tooth type please check chain compatibility in page 38

### SPECIFICATIONS

REF. 301

**Material**  
Aluminium  
Steel

**Teeth\***  
32T to 52T and 56T

**Weight (g)\*\***  
47

**Finishes**  
Anodized

## Chainflow BCD104



\* other sizes available by request

\*\* with 40T Chainring

In order to choose tooth type please check chain compatibility in page 38

### SPECIFICATIONS

REF. 302

**Material**  
Aluminium  
Steel

**Teeth\***  
32T to 44T and  
48T to 52T

**Weight (g)\*\***  
66

**Finishes**  
Standard

## Standard Chainring



\* other sizes available by request

In order to choose tooth type please check chain compatibility in page 38

### SPECIFICATIONS

REF. 303

**Material**  
Aluminium  
Steel

**Teeth\***  
32T to 52T and  
56T

**Weight (g)**  
40 to 277

**Finishes**  
Standard



**CF3D**  
REF. 400



**Material**  
Aluminium

**BCD**  
104

**Finishes**  
Standard

**TS GRAPHIC**  
REF. 402



**Material**  
Aluminium

**BCD**  
104

**Finishes**  
Standard

**NW GRAPHIC**  
REF. 406



**Material**  
Aluminium

**BCD**  
104

**Finishes**  
Standard

# CHAINGUARDS

[www.mirandabikeparts.com](http://www.mirandabikeparts.com)





At Miranda, we believe in the power of individuality and we understand that every bike manufacturer has unique needs and specifications. This is why we take pride in offering custom chainguard designs, enabling you to tailor our products to your exact requirements. Our custom-designed chainguards allow you to add a personal touch to each bike you create, ensuring a unique finish that sets your brand apart.

Crafted with high-quality materials, our chainguards promise durability and longevity, standing up to even the most rigorous riding conditions. Our commitment to precision and quality is unwavering, ensuring that every Miranda chainguard you choose is a testament to our dedication to excellence.

Whether you're catering to the needs of the urban commuter or the off-road explorer, there's a Miranda chainguard tailored to fit. Custom designs can also be developed by request, to give that distinct and unique look to the bicycle.

### CF3D BCD110

REF. 401



**Material**  
Aluminium

**BCD**  
110

**Finishes**  
Standard

### TJ

REF. 403



**Material**  
Aluminium or  
Reinforced Nylon

**BCD**  
104

**Finishes**  
Standard

### ST CNC

REF. 404



**Material**  
Aluminium

**BCD**  
104

**Finishes**  
Standard

### TB GRAPHIC

REF. 405



**Material**  
Aluminium

**BCD**  
104

**Finishes**  
Standard

### WR GRAPHIC

REF. 407



**Material**  
Aluminium

**BCD**  
104

**Finishes**  
Standard

### SL

REF. 408



**Material**  
Aluminium or  
Reinforced Nylon

**BCD**  
104

**Finishes**  
Standard

### DOUBLE

REF. 409



**Material**  
Aluminium

**BCD**  
104

**Finishes**  
Standard





# SCREWS

## M14 Self extracting bolts

REF. 808

*Micanda*  
**X700**

**Material**  
Steel

**Coating**  
Zinc-nickel



## Chainring screw and nuts

REF. 810

M8x0,75  
for chainring set  
or chainring+chainguard set

**Material**  
Stainless Steel



**M15**

REF. 804

**Material**  
Steel**Coating**  
Zinc-nickel

\*steel spindle

**M15 Self extracting bolts**

REF. 809

**Material**  
Steel**Coating**  
Zinc-nickel

\*steel spindle

**M12**

REF. 802

**Material**  
Steel**Coating**  
Zinc-nickel

\*aluminium spindle

**M12 Self extracting bolts**

REF. 807

**Material**  
Steel**Coating**  
Zinc-nickel

\*aluminium spindle

**M8**

REF. 800

**Material**  
Steel**Coating**  
Zinc-nickel**M8 Self extractinga bolts**

REF. 805

**Material**  
Steel**Coating**  
Zinc-nickel



# FINISHES

## STANDARD (PAINTING)\*



## PEARL



## PLUS



## \*COLORS AVAILABLE

Other colors or personalized finishes by request

<b>Black</b> Smooth surface	<b>Anodized</b> Smooth surface	<b>Ocean blue</b> Smooth surface	<b>Red</b> Smooth surface
<b>Black textured</b> Textured surface	<b>Chrome painting</b> Smooth surface	<b>Sky blue</b> Smooth surface	<b>Coral red</b> Smooth surface
<b>Black granited</b> Rough surface	<b>Gray</b> Smooth surface	<b>Green</b> Smooth surface	<b>Metallic orange</b> Smooth surface
<b>White</b> Textured surface	<b>Champagne</b> Rough surface	<b>Pure green</b> Smooth surface	<b>Magenta</b> Smooth surface

## DIAMANT







# BELT LINE GUIDE

CODE	MANUFACTURER	DESCRIPTION	MODEL NUMBER	BELT LINE
EN-455	Enviolo	TR, SP, CA	132/142	45,5 mm
EN-487		SP	148 Boost	48,5 mm
SH-417	Shimano	Inter-5E	Di2	41,7 mm
SH-455			Mechanical	45,5 mm
SH-417		Nexus 8	Di2	41,7 mm
SH-455			Mechanical	45,5 mm
RO-547	Rohloff	500/14	132/142	54,7 mm

**INLINE****POLISHED****DOUBLE DIAMANT****GRAPHIC****HD****INLINE PLUS**

# CHAIN COMPATIBILITY

Tooth type					
Tooth name	<b>STANDARD CHAINRINGS</b>	<b>CHAIN FLOW</b>	<b>CHAIN FLOW 3D</b>	<b>CHAIN FLOW SE12</b>	<b>CHAIN FLOW CE13</b>
Recommended chain	All 7, 8, 9, and 10 speed chains	All 9, 10 and 11 speed chains	9, 10, 11 speed chains and Sram Eagle non T-type	Designed for Sram Eagle and Road 12 speed T-type, 12 speed Shimano Hyperglide+, KMC DLC and X12	Designed for 13 speed EKAR C13 Campagnolo
Not recommended	11, 12 and 13 speed chains	12 and 13 speed chains	Sram Eagle and Road 12 speed T-type, 12 speed Shimano Hyperglide+, KMC DLC and X12 and 13 speed chains	13 speed chains	-----

# 2026

***Miranda***

Miranda & Irmão, Lda  
EN1 Km228.9, Borralha  
3750-871 - Águeda, Portugal  
N 40 32.820 W 8 26.825

**Email**  
info@miranda.pt  
**Telephone**  
+351 234 612 796

**www.mirandabikeparts.com**  
**@mirandabikeparts**

**Download Digital Catalog**



Miranda and the 'Miranda' logo are trade marks and are registered in numerous jurisdictions around the world.  
© Copyright 2023 . Miranda e Irmão, Lda.  
All rights reserved.

Cofinanciado por:



DICOM03/02